

1  
RoHS Compliant

2  
Pb HF

| REV. | ECN NO. | DESCRIPTION | DRWN | APPD | DATE |
|------|---------|-------------|------|------|------|
|      |         |             |      |      |      |

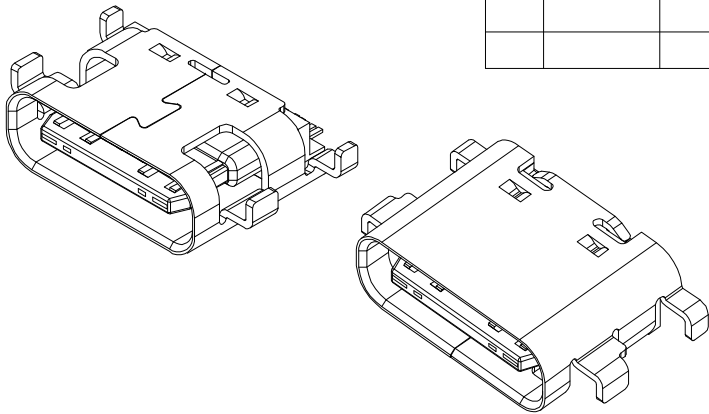
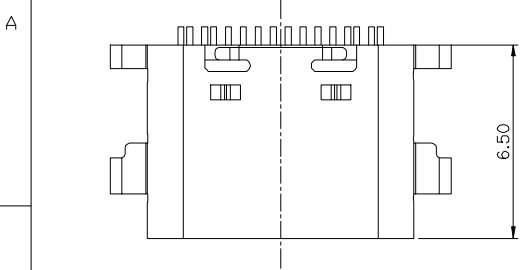

1.MATERIAL:  
MOLDING: LCP UL94 V-0  
CONTACT: COPPER ALLOY.  
GOLD PLATED ON CONTACT AREA, 100u"  
Min TIN (LEAD FREE) ON SOLDER AREA,  
SHELL: SUS304-H,T=0.30±0.03mm  
50u" NICKEL PLATING OVER ALL.  
SHILD: SUS304-H,T=0.12±0.03mm

2.MECHANICAL:  
INSERTION: 5~20N.  
EXTRACTION: 8~20N.  
DURABILITY: 5000 CYCLES

3.ELECTRICAL:  
CURRENT: 3A MIN FOR VBUS;

VOLTAGE: 5VAC MAX  
WITHSTANDING VOLTAGE: 100V AC.  
CONTACT RESISTANCE: 40mΩ MAX.  
INSULATION RESISTANCE: 100MΩ MIN.

4.ENVIRONMENTAL  
TEMPERATURE RANGE -55°C ~ +85°C

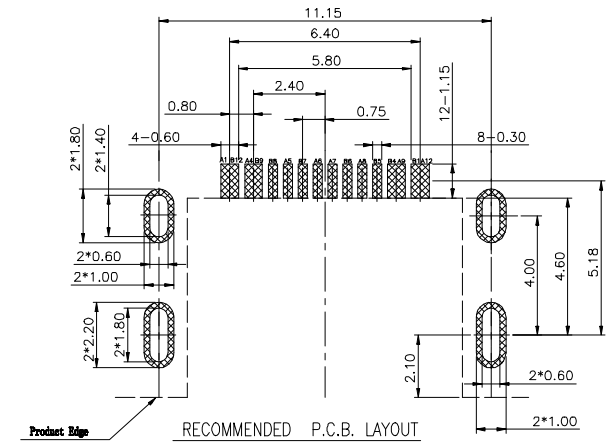
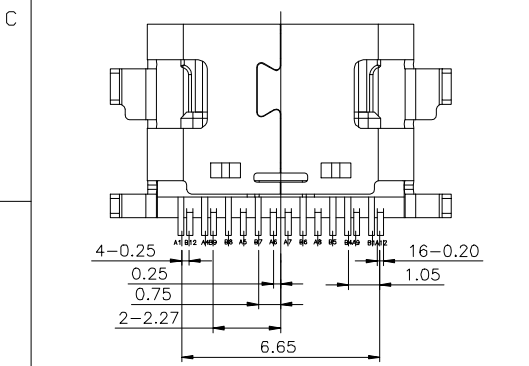
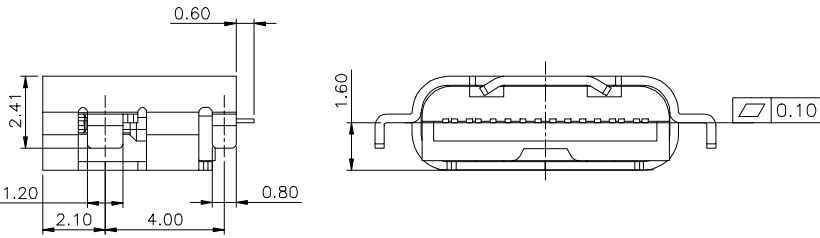
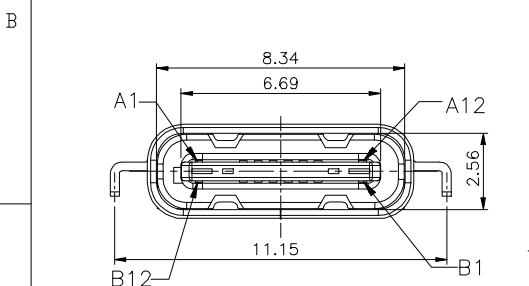

|     |             |     |             |
|-----|-------------|-----|-------------|
| A1  | GND         | B12 | GND         |
| A4  | VBUS        | B9  | VBUS        |
| A5  | CC1         | B8  | SBU2        |
| A6  | DP1         | B7  | DN2         |
| A7  | DN1         | B6  | DP2         |
| A8  | SBU1        | B5  | CC2         |
| A9  | VBUS        | B4  | VBUS        |
| A12 | GND         | B1  | GND         |
| PIN | SIGNAL NAME | PIN | SIGNAL NAME |

D

GENERAL TOLERANCE:  
0. ±0.38  
0.0 ±0.25  
0.00 ±0.15  
0.0° ±2°

DATE:  
DR.:  
CHK.:  
APPD:

**深圳市连欣科技有限公司**

TITLE:  
3.1 TYPE C 16PF SMT 沉板母座  
单排短体6.50L 沉板1.6全Molding

REV.: A0  
SHEET: 1of1  
SIZE: A4

PART NO.: **XDBF-0316-2033**  
UNITS: mm  
SCALE: 1:1